

## HOLIDAY ASSIGNMENTS FOR SS 2 PROMOTED TO SS 3

### 1. MATHEMATICS

1. The probability that two hunters P and Q hit their targets are  $\frac{2}{3}$  and  $\frac{3}{4}$  respectively. The two hunters aim at a target together. What is the probability that;
  - a.
    - i. they both miss the target;
    - ii. they both hit?
  - b. If the target is hit, what is the probability that only one of them hits it?
2. The diameter of a circle centre O is 26cm. If a chord  $\overline{PQ}$  is drawn such that it is 5cm from O to the centre of the chord, calculate, correct to the nearest whole number, the:
  - a.  $\angle POQ$
  - b. area of the major segment formed by the chord  $\overline{PQ}$ .  
[Take  $\pi = \frac{22}{7}$ ]

### 2. ENGLISH LANGUAGE

#### I. COMPREHENSION

New Oxford Secondary English Course for SS3

Page 20: a-g

#### II. GRAMMAR

**Use neither... nor to make a sentence from each pair of sentences.**

1. I did not like her. I did not trust her.
2. We did not have the money. We did not have the time.
3. We will not ask for advice. We will not take advice.
4. Audi cannot type my letters accurately. She cannot file my papers correctly
5. The classroom floor has not been swept. The classroom floor has not been washed.

**State the grammatical name and grammatical function the underlines expression in the following sentences:**

6. Nothing was gained, though it was a long holiday.
7. I know that you are angry.
8. He ordered a meal of roast plantain and groundnut.
9. The speaker talked more extensively than required on health matters.
10. Wherever you are, be good.

### III. SUMMARY

New Oxford Secondary English Course for SS3

Page 22: Summary

### IV. SPEECH

**Choose the correct options from the following options.**

1. Paper A. Physical B. Lap C. Psalm D. Friend
2. Did A. Land B. Handsome C. Lamp. D. Lamb
3. Street A. Sleep B. Straight C. Stop D. Search
4. Which A. Who B. Wash C. Whose D. How
5. Think A. These B. Them C. Thank D. Search

6./e/

- A. week
- B. leap
- C. many
- D. receive

7./j/

- A. meal
- B. wanted
- C. yes
- D. fight

8./æ/

- A. plait
- B. mate
- C. came
- D. father

9/ ɔ: /

- A. cot
- B. claw
- C. young
- D. plough

10/ʌ/

- A. money
- B. shirt
- C. word

D. sword

**3. FINANCIAL ACCOUNT**

1. Define the following:
  - i. Ratio
  - ii. Accounting ratio
2. Extensively explain the classifications of accounting ratios
  - i. Profitability ratio
  - ii. Liquidity ratio
  - iii. Investment ratio

**4. COMMERCE**

1. Write short notes on the following:
  - a. Importing
  - b. Exporting
  - c. Warehousing
- 2a. What is Commercialisation?
- b. State any two Nationalised industries in Nigeria.
- c. Explain industry as a division of occupation.

**5. ECONOMICS**

In recent times, developing countries that are predominantly agriculture-oriented are searching for ways of diversifying their economies. Many of these countries strives to exploit the available solid material deposits in their land as a means of promoting industrialization.

*In view of the above statement.*

- (a) Define the term:
  - (I) Industrialization;
  - (II) Mineral resources.
- (b) Apart from promoting industrialization, identify any **three** benefits of exploiting mineral deposits.
- (c) Identify any **three** benefits of industrialization to developing country.

**6. CHRISTIAN RELIGIOUS STUDIES**

- 1a. Succinctly discuss the birth of Jesus according to St. Luke.

- b. What **FOUR (4)** lessons can be drawn from the birth of Jesus?
  - c. Mention all the disciplines of Jesus.
- 2a. Examine the baptism of Jesus as narrated in Matthew's Gospel.
  - b. In what **FOUR (4)** ways is baptism relevant to Christians?
  - c. Mention any **FOUR (4)** lessons that could be drawn from Gideon's leadership.

## 7. GOVERNMENT

- 1a. Highlight briefly the features of Hausa/Fulani pre-colonial political system.
  - b. Who are the age grades? Mention any **FIVE (5)** of their roles in the traditional Igbo political system.
  - c. Explain any **FOUR (4)** checks and balances that were put in place in the pre-colonial Yoruba political system.
- 2a. Define colonialism.
  - b. Explain any **FOUR (4)** reasons for the success of indirect rule system in Northern Nigeria.
  - c. What do you understand by policy of Association?

## 8. CIVIC EDUCATION

- 1a. What do you understand by Human Rights?
- b. Enumerate any **FIVE (5)** attributes of human rights.
- c. Explain any **THREE (3)** attributes of human rights highlighted above.
- 2a. In a sequential order, explain the generations of human rights according to Karel Vasak.
- b. Highlight any **FOUR (4)** limitations to human rights.
- c. What do you understand by public service?

## 9. ISLAMIC RELIGIOUS STUDIES

- 1a. Write Suratul Ikhlas in either Arabic or transliteration.
  - b. State any **FIVE (5)** teachings of Suratul Ikhlas.
  - c. Give an account of the contributions of Caliph Abu Bakr to Islam.
- 2a. Define the term Shirk.

- b. Explain with **THREE (3)** examples each, the two types of Shirk.
- c. Enumerate any **FOUR (4)** prophets of Allah.

## 10. YORUBA LANGUAGE

- 1a. Fún ìwà ọmọ́lúàbí ní oríkì
- 1b. Kọ méjì sílẹ̀ lára àwọn àbùdá ọmọ́lúàbí.
- 1c. Ẹ̀e àkọ́sílẹ̀ mejì lára àlẹ́bù kí ènìyàn má jẹ ọmọ́lúàbí
- 2a. Kọ mejì sílẹ̀ lára ànfààní jíjẹ ọmọ́lúàbí.
- 2b. Fún lẹ̀tà àìgbẹ̀fẹ̀ ní oríkì.
- 2c. Kọmẹ̀jì sílẹ̀ lára àwọn ìgbésẹ̀ tí o wà fún kíkọ lẹ̀tà àìgbẹ̀fẹ̀.

## 11. FRENCH LANGUAGE

- 1. Conjuguez les verbes suivants: A. au passe composé, B. à l'imparfait, C. au Futur et D. à l'impératif.
  - i. Voir
  - ii. Acheter
  - iii. Prier
- 2. Rédaction: Expression Écrite.  
 Answer only one question in this section. Your essay should be written in French language and in no less than 250 words.
  - i. Parlez de votre pays.
  - ii. Parlez de votre meilleur (e) professeur.
  - iii. Parlez de votre ami (e) intime.
- 3. Letter writing.  
 Answer only one question in this section. Your letter should be written in French language and in no less than 225 words.
  - i. Écrivez une lettre pour inviter un ami / une amie à votre anniversaire.
  - ii. Écrivez une lettre à votre correspondant (e) français (e). Parlez lui de votre famille.
  - iii. Votre père vous a remis de l'argent pour acheter un dictionnaire français. Écrivez une lettre à votre père pour lui remercier.

## 12. LITERATURE

### OBJECTIVES

1. The moon looked on the massacre in horror ! illustrates  
A. pathetic fallacy  
B. prologue  
C. epilogue  
D. transferred epithet

2. A dead metaphor is  
A. overused and ineffective  
B. implied and not funny  
C. implied and underused  
D. overused and funny

3. The third stanza of the Shakespearean sonnet is  
A. couplet  
B. sextet  
C. octave  
D. quatrain

Read the poem below and answer the question below:

Miniver Cheevy, child of scorn,  
Grew lean while he assailed the season; He wept that he was ever born,  
And he had reasons.  
Miniver loved the days of old  
When swords were bright and steeds prancing; The vision of a warrior bold  
Would set him dancing.

4. "child of scorn" illustrates  
A. euphemism  
B. contrast  
B. metaphor  
D. metonymy

5. The metrical structure is predominantly  
A. trochaic  
B. dactylic  
C. iambic  
D. spondaic

6. Reading the poem, one notices that the poet is being

- A. hyperbolic
- B. euphemistic
- C. ironic
- D. sarcastic

7. In the last stanza, the persona is

- A. fantasizing
- B. angry
- C. malnourished
- D. pretending

8. The two stanzas are built on

- A. alternate rhyme
- B. identical rhymes
- C. couplets
- D. run-on lines

### **UNSEEN PROSE AND POETRY**

Read the passage below and answer the following questions:

Along marched the crowd, determined not to be distracted from its cause and the course it had charted. If anyone could intimidate the chief, it was Sasu, who led the crowd. The chief nurtured unruffled restraint. He knew Sasu, knew that Sasu would not waste the trust between them on renegades.

One way to divert a mob from its goal is to join in with it, lead it on, but, finally, veer it from the course of its cause. Onward, towards the chief's palace marched the crowd, singing war songs.

The sun frowned as the palace guards, rattling like leaves in a storm - fear branded on their faces, came out to survey the threatening crowd and prepare for a siege. Just then, Sasu turned about, heading away from the palace - with the crowd, and the war songs.

9. The prevailing atmosphere is

- A. pleasant
- B. drab
- C. tense
- D. serene

10. "join in with it, lead it on, but, finally, veer it from..." illustrates

- A. allusion

- B. simile
- C. parallelism
- D. personification

### **13. COMPUTER STUDIES**

1. Define the term "networking".
2. Identify and describe the different types of networking.
3. Explain the differences between star topology and bus topology.
4. Draw and label a ring network structure.
5. List and describe three common network devices.

### **14. DATA PROCESSING**

1. What is a data model, and why is it important in database design?
2. Compare and contrast the three primary types of data models: conceptual, logical, and physical.
3. Explain the entity-relationship (ER) model. What are its key components, and how do they relate to each other?
4. What are normalization and denormalization in the context of relational databases?
5. Describe the differences between a hierarchical data model, a network data model, and a relational data model. What are the typical use cases for each?



## 15. FURTHER MATHEMATICS

1.

Vectors **a**, **b** and **c** are such that  $\mathbf{a} = \begin{pmatrix} 4 \\ 3 \end{pmatrix}$ ,  $\mathbf{b} = \begin{pmatrix} 2 \\ 2 \end{pmatrix}$  and  $\mathbf{c} = \begin{pmatrix} -5 \\ 2 \end{pmatrix}$ .

(i) Show that  $|\mathbf{a}| = |\mathbf{b} + \mathbf{c}|$ .

(ii) Given that  $\lambda\mathbf{a} + \mu\mathbf{b} = 7\mathbf{c}$ , find the value of  $\lambda$  and of  $\mu$ .

2.

(i) Given that  $n$  is a positive integer, find the first 3 terms in the expansion of  $\left(1 + \frac{1}{2}x\right)^n$  in ascending powers of  $x$ .

(ii) Given that the coefficient of  $x^2$  in the expansion of  $(1 - x)\left(1 + \frac{1}{2}x\right)^n$  is  $\frac{25}{4}$ , find the value of  $n$ .

## 16. CHEMISTRY

1. In a laboratory procedure for preparing  $\text{ZnSO}_4$ . A solid  $x$  was added with stirring to warm, dilute  $\text{H}_2\text{SO}_4$ , until no more of it dissolved excess of  $x$  was removed from the reaction mixture. The solution of  $\text{ZnSO}_4$  obtained was concentrated to a small volume and then set aside.
    - a. Suggest three substance which  $x$  could be.
    - b. Name the method use for removing excess of  $x$
    - c. What method was used to concentrated the  $\text{ZnSO}_4(\text{aq})$ ?
  - 2a. Explain why some metals occur as free elements in nature while others occurs in combined form giving two examples of each type.
  - b. How does sodium hydroxide react with metallic zinc and Aluminum respectively? Give the equation of the reaction.
  - c. How is metallic sodium usually stored and explain why it is thus stored
  - d. Give the method of extraction of the following metals; (i) Na (ii) Gold
- (iii) mercury (iv) zinc

## 17. BIOLOGY

- 1a. State the four components of a fruit.
- 1b. Briefly explain the process of double fertilization in flowering plants.
- 1c. In a tabular form, state three differences between seed and fruit.

2a. State the function of the following part of a flower:

- i. Ovary
- ii. Micropyle
- iii. Pollen

2b. Give two examples each of:

- i. true fruit
- ii. false fruit
- iii. Aggregate fruit

2c. Differentiate between dehiscent and indehiscent fruit

## **18. PHYSICS**

- 1a. State Coulomb law
- 1b. What is electric potential
- 1c. Calculate the electric potential at a distance of 20.0 cm from a point charge of 0.015C placed in air of permittivity.
- 2a. The capacitance of a parallel plate capacitor when in air is 3 $\mu$ f and in the presence of a dielectric material 6 $\mu$ f. The dielectric constant is
- 2b. Define resistivity
- 2c. A 2m wire of resistivity  $5.5 \times 10^{-7}$  ohmsmeter has a cross-sectional area of 0.50m<sup>2</sup>. Calculate its resistance.

## **19. GEOGRAPHY**

- 1a. Define climate change.
- 1b. State and explain the causes of climate change.
- 1c. Outline five (5) consequences of climate change.
- 2a. State the meaning and composition of Ecowas.
- 2b. State five(5) aims and objectives of Ecowas.
- 2c. Discuss five (5) problems of Ecowas.

## 20. FURNITURE MAKING

A WALL TOILET CABINET

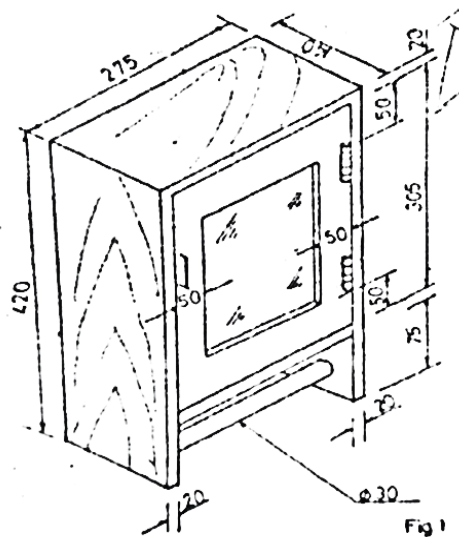

1. The drawing shown above is the isometric projection of a wall toilet cabinet.  
Attach to the cabinet is a mirror and a towel rail. Study and draw to scale 1.5, the
  - a. Front elevation
  - b. End elevation
  - c. Plan
2. Sketch an exploded pictorial view of the joint between the towel rail and one side of the wall cabinet shown above
3. (a) Make a neat sketch of a claw hammer  
(b) State two major functions of the claw hammer

## 21. VIRUTAL ART

1. Write briefly on the following African art, considering their origin, location, features and characteristics;
  - I. Ibibio mask
  - II. Baule art tradition.
  - III. Bobo mask
  - IV. Esie soap sculpture
- 2a. Explained Egyptian art culture
- b. State five god's of the Egyptians

- c. Mention two features of the Egyptians art.
- 3. Write briefly on the following Renaissance artists
  - I. Lenado da Vinci
  - II. Huge ball
  - III. Micheal Angelo

## 22. DYEING AND BLEACHING

- 1a. Define planography.
- b. List 5 materials used in screen printing.
- 2a. State the steps in creating a batik dsign.
- b. Highlight two (2) differences between printing and tie-dye.
- 3. What is “bolting” in tie-dye?

## 23. TECHNICAL DRAWING

### QUESTION 1

- (a) Draw a regular pentagon of sides 30mm and construct its involutes
- (b) i. Construct an escribed circle to a triangle of sides 50, 65, and 75 to touch the shortest side of the triangle
- ii. Measure and state the radius of the circle

### QUESTION 2

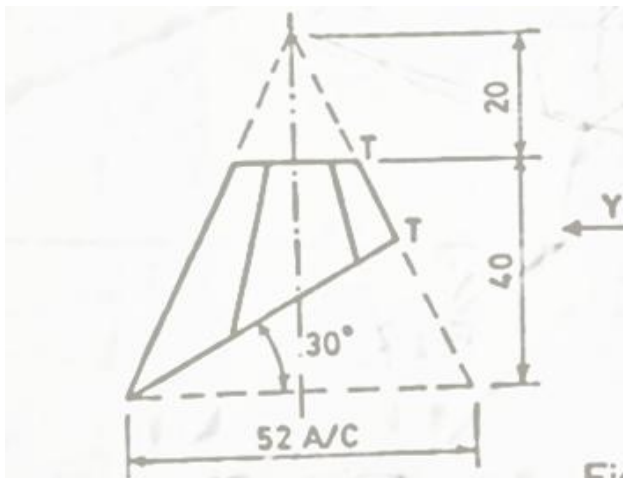
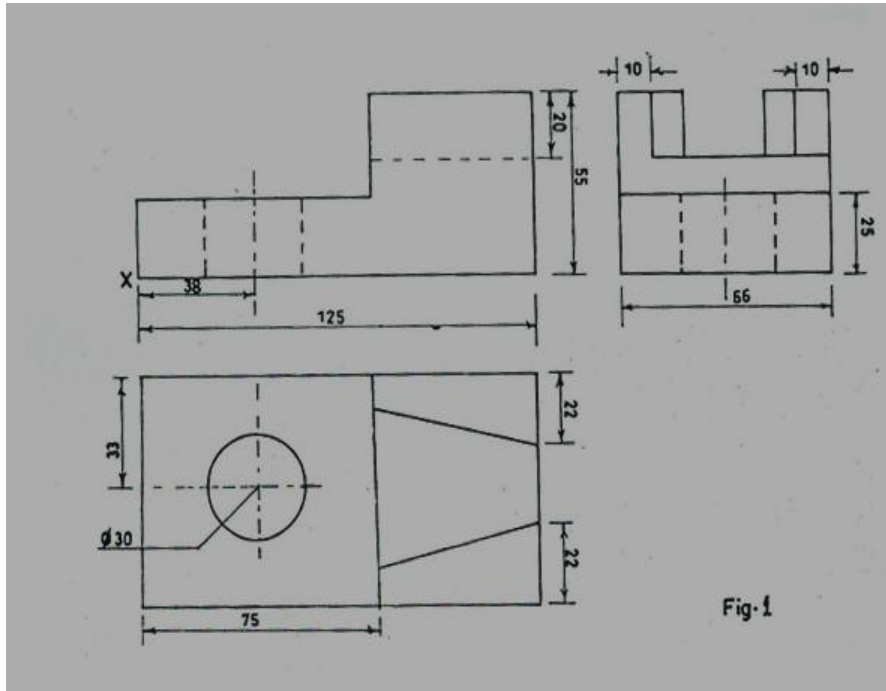

Fig. 2

Fig. 2 shows a truncated hexagonal pyramid. Draw full size, in first angle projection, the

- a. Given view
- b. End view in the direction of arrow Y,
- c. Plan;
- d. Surface development with T-T as seam.

### QUESTION 3



- (a) Figure 1 above shows a block in orthographic project. Construct the isometric projection of the block making X the lowest point.
- (b) Make a freehand pictorial sketch of a bolster
- (c) Make a freehand pictorial sketch of a straight snip

### 24. AGRICULTURAL SCIENCE

1a.

Price (#)	Quantity supplied (kg)
100	50
80	40
60	30
40	20
20	10

Use the information above to prepare a supply curve.

b. Define crop improvement.

2a. State 3 methods of crop improvement and explain one.

b. State the law of diminishing returns.

c. As an agricultural Science student, proffer two possible suggestions to a crop farmer who had a diminishing return experience on his farm.